

ACCOMMODATIONS SYMBOL LEGEND

- ▲ Twin Bed and Single Sofa Bed
- ★ 2 Twin Beds (convert to King) and Single Sofa Bed
- 2 Twin Beds (convert to King) and 1 Upper Pullman
- 2 Twin Beds (convert to King) and 2 Upper Pullmans
- 2 Twin Beds (convert to King), Single Sofa Bed and 1 Upper Pullman

- † 2 Twin Beds (convert to King) and Double Sofa Bed
- ◆ Stateroom with 2 Porthole Windows
- ◁ Connecting staterooms (ideal for families and groups of friends)
- ★ Twin Beds do not convert to a King Bed.
- U Unisex Wheelchair Accessible Restroom

All accommodations are non-smoking. Staterooms are available that are modified for wheelchair users. Please contact Carnival Reservations Department, Guest Access Services, at 1-800-438-6744, ext. 70025, for details.

CATEGORIES

- 1A Interior Upper/Lower
- P1 Porthole
- 4A 4B 4C 4D 4E 4F 4G Interior
- 4I Interior with Picture Window (obstructed views)
- 6A 6B 6C Ocean View
- 8A 8B 8C 8D 8E 8F Balcony
- 8M 8N Aft-View Extended Balcony
- 9C Premium Vista Balcony
- JS Junior Suite
- OS Ocean Suite
- GS Grand Suite

45 Interior 65 Ocean View (obstructed views) 8P 8S Balcony SS Suite Spa accommodations include private access, special amenities and priority reservations at the Cloud 9 Spa.

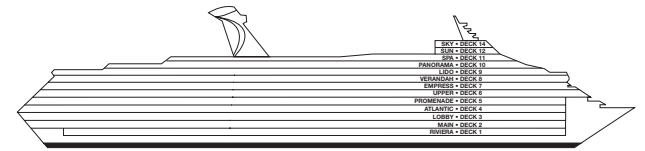

Gross Tonnage: 113,300 Length: 952 Feet Beam: 116 Feet
 Cruising Speed: 21 Knots Guest Capacity: 3,002 (Double Occupancy)
 Total Staff: 1,150 Registry: Panama



Riviera • Deck 1

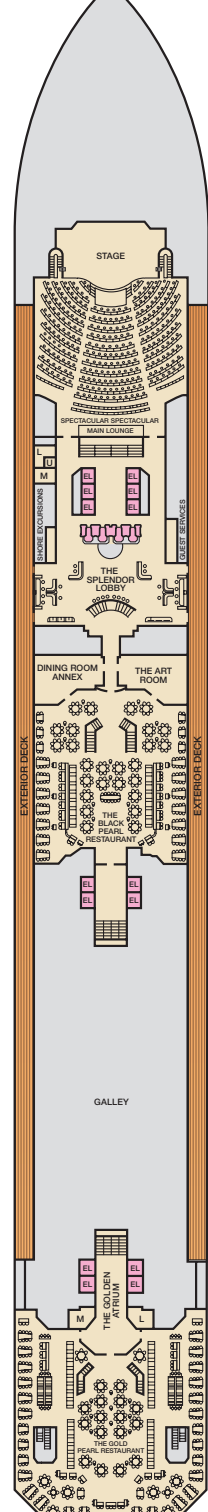

Main • Deck 2

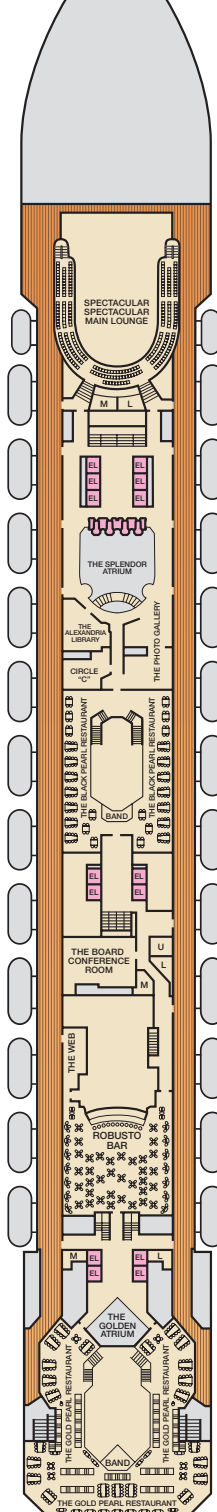

Lobby • Deck 3

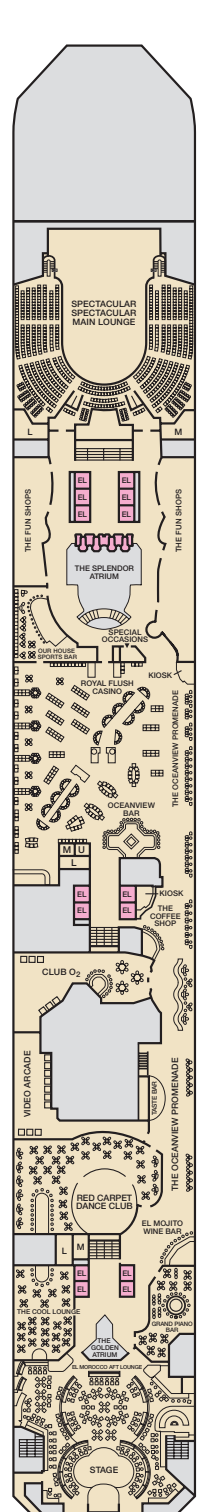

Atlantic • Deck 4

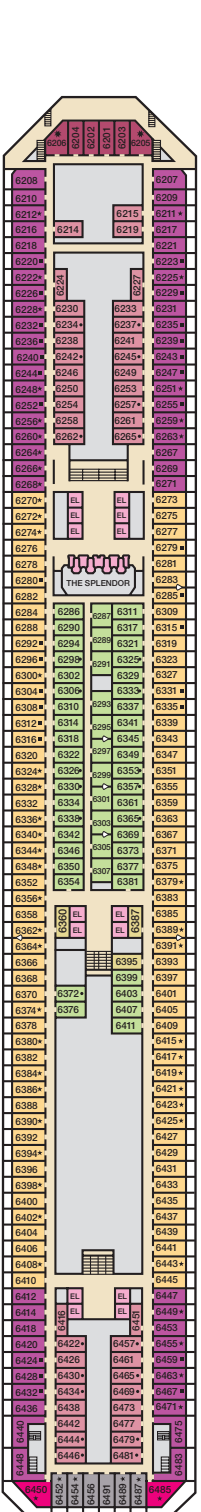

Promenade • Deck 5

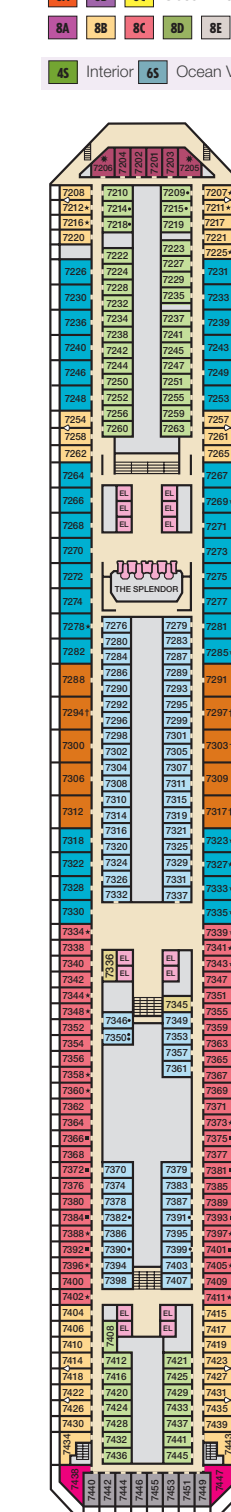

Upper • Deck 6

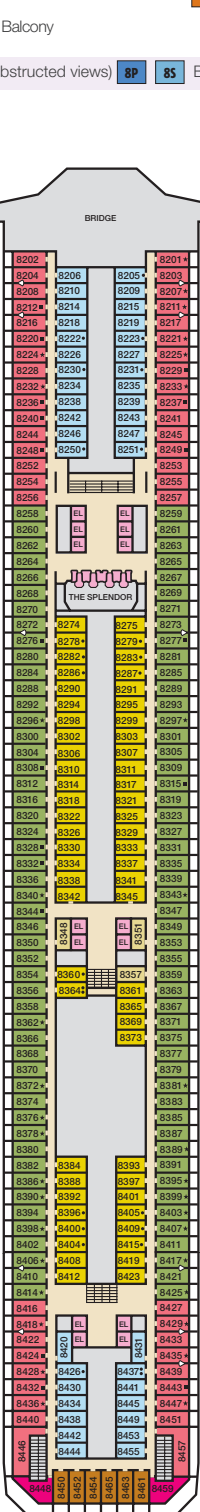

Empress • Deck 7

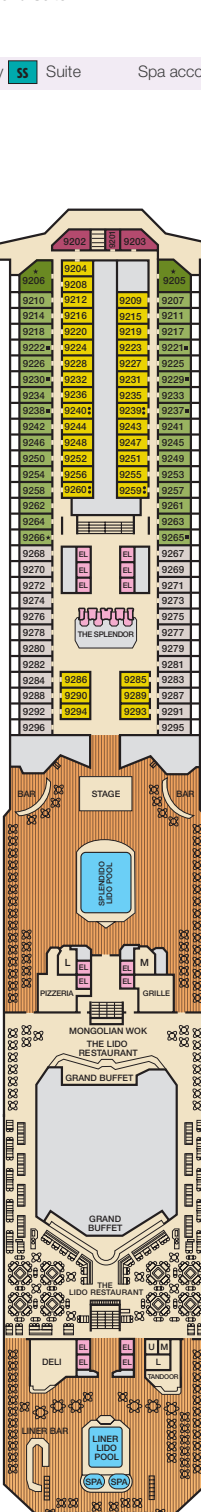

Verandah • Deck 8

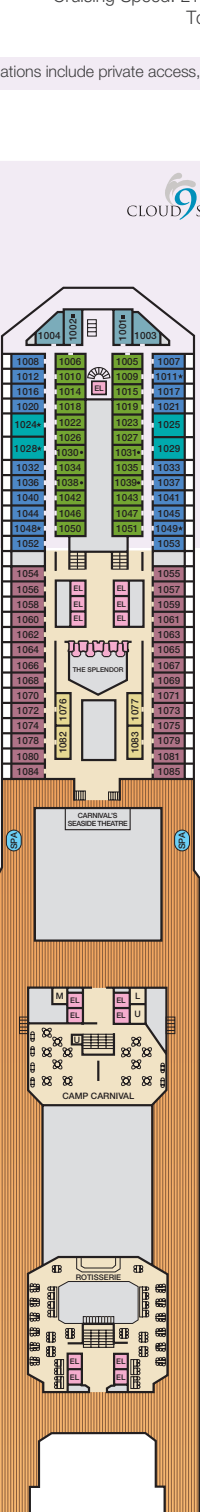

Lido • Deck 9

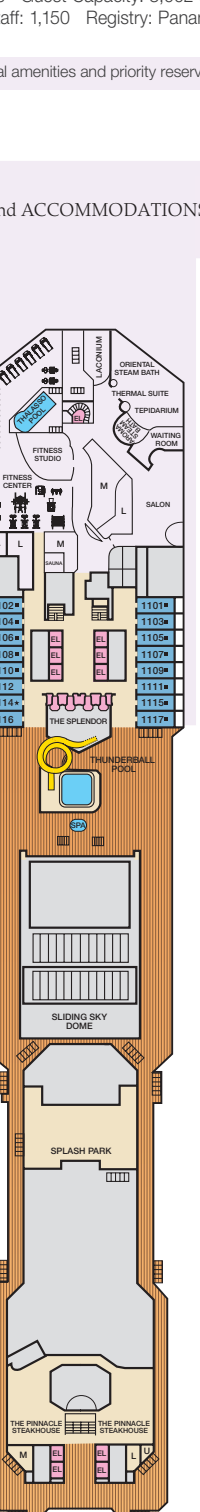

Panorama • Deck 10

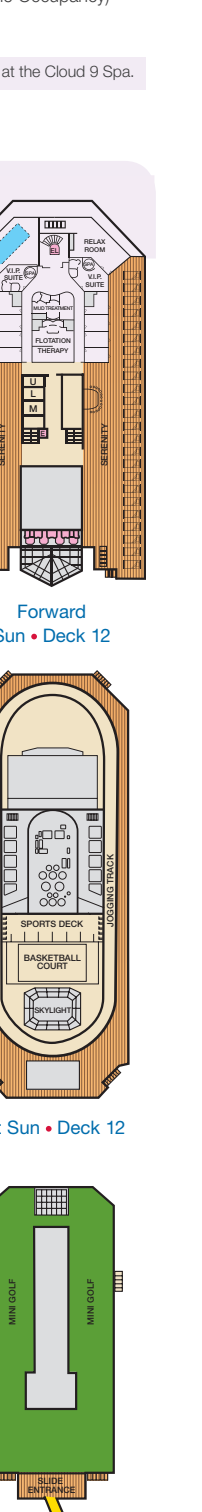

Spa • Deck 11

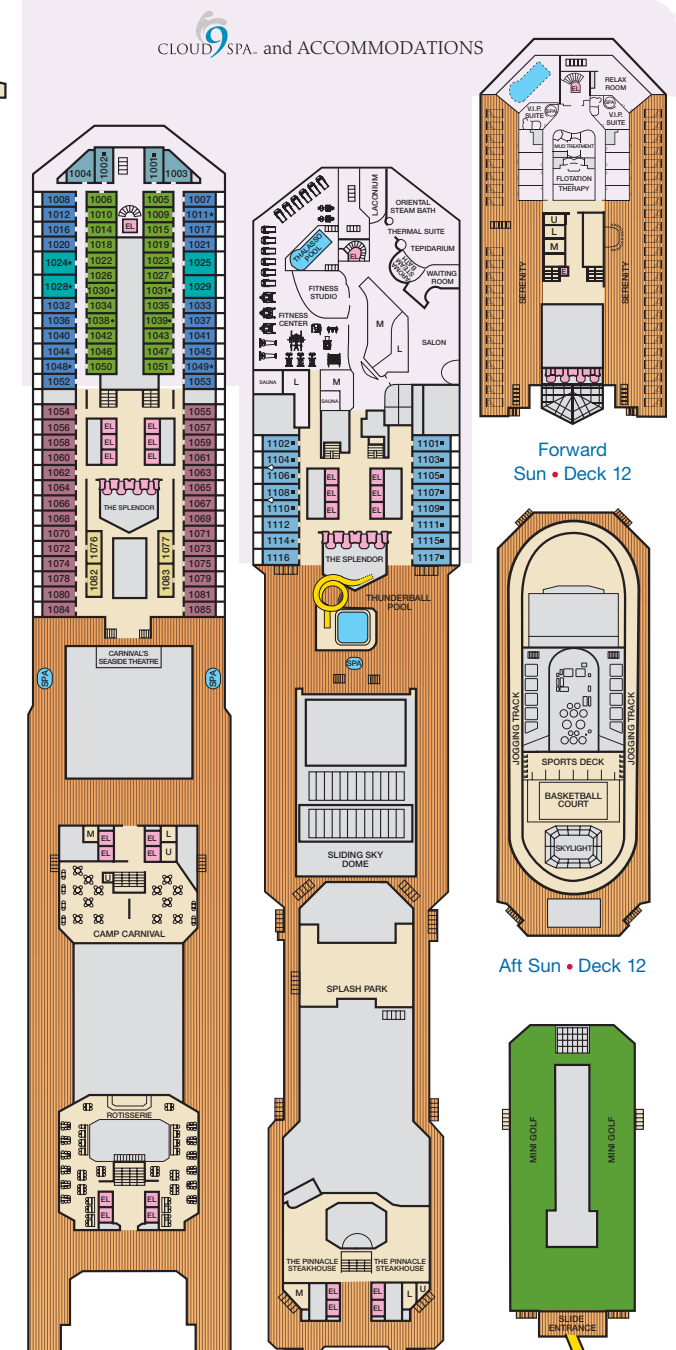

Sky • Deck 14